

## PANDUAN (WI) MENGGUNAKAN PLAGSCAN UNTUK TEACHER

1. Buka web plagscan : → <http://www.plagscan.com/unika>

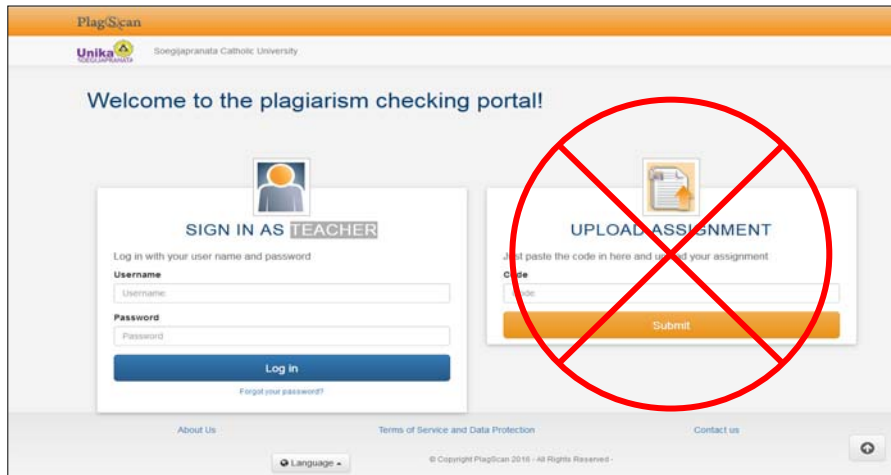

2. Masuk Login yang sudah dibuatkan oleh Top Manager

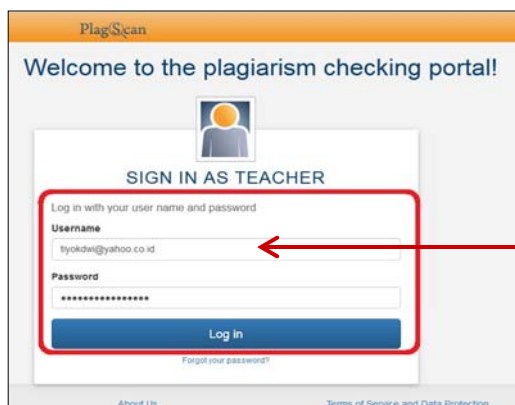

Ketik  
*Username* dan *password*

Yang sudah dibuatkan oleh Top Manager  
Kemudian klik *Log in*

3. Merubah **Plagiarism level** (Level Prosentase)

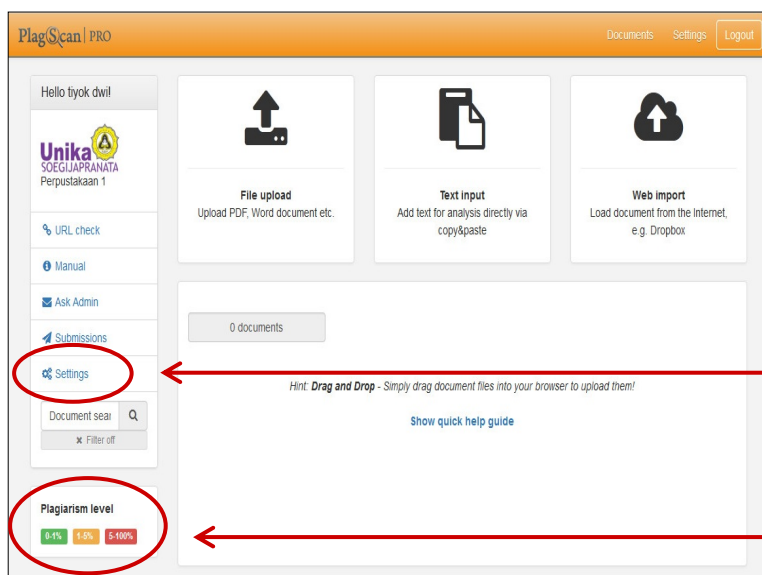

Klik **Settings**:  
Untuk merubah  
**Plagiarism  
level**

Plagiarism level

0-10% 10-20% 20-100%

## Merubah *Plagiarism level* (Level Prosentase)

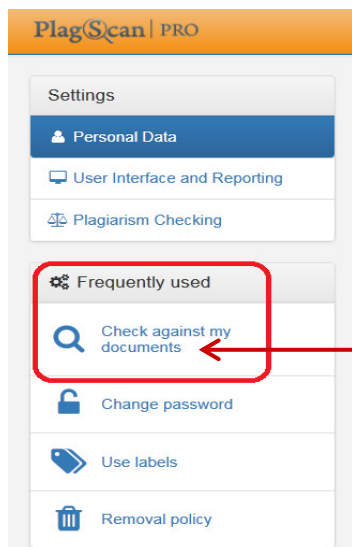

Klik ***Check against my documents***

Untuk merubah settingan prosentase dan lain-lain  
(lihat gambar berikut)



#### 4. Menyeting *upload* mandiri (*New Class*)

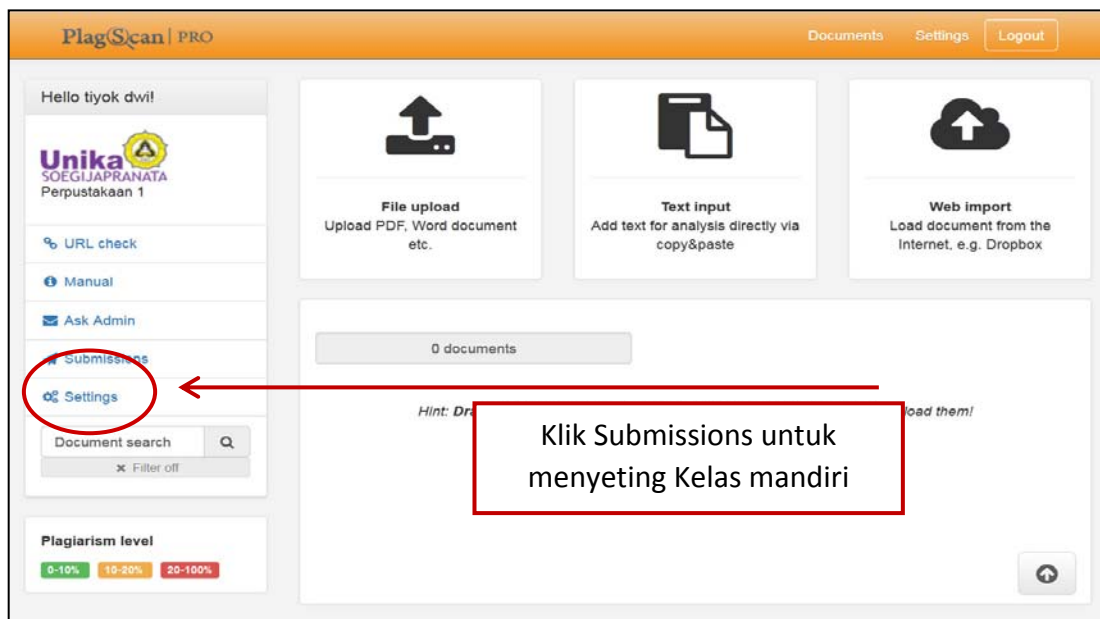

#### CONTOH :

Submissions

Create filing codes here for students/authors to submit papers directly to your account <https://www.plagscan.com/unika>.

Title:  Tulis Proram Studi

Label:  Tulis Jenis yang akan discan

Deadline: ☒ No deadline Klik No deadline

Note to uploader:  Dapat ditambahkan komentar disini

Share results: ☒ Send plagiarism report to uploader Klik Send plagiarism ...

Submissions

Show advanced options

☒ Automatically analyze at deadline ☐ Send summary email at deadline ☒ Allow to update the submissions

Max. number of total uploads ☒ Unlimited

Klik semua sesuai petunjuk gambar ini

Klik Create

Create

Cancel

Hasil setingan sebagai berikut

The screenshot shows the 'Submissions' interface of Plagscan. At the top, there is a header 'Submissions' with a close button. Below it, a grey box contains the text: 'Create filing codes here for students/authors to submit papers directly to your account <https://www.plagscan.com/unika>'. A blue button labeled 'Create new submission' is highlighted with a red box. Below this is a table with the following columns: Title, Label, Deadline, and Code. The first row of the table has the following data: Title: 'Program Studi ARSITEKTUR', Label: 'TUGAS AKHIR', Deadline: '-', and Code: 'xmpL2Yk'. The 'Code' column is highlighted with a red box. Below the table, there are four icons: a pencil, a document, a trash can, and an information icon. Two red arrows point from text boxes to the interface. The first arrow points from the text box 'Klik *Create new submission* untuk membuat kelas baru' to the 'Create new submission' button. The second arrow points from the text box 'Kode kelas untuk masuk login upload' to the 'Code' column.

Submissions

Create filing codes here for students/authors to submit papers directly to your account <https://www.plagscan.com/unika>

Create new submission

Title	Label	Deadline	Code
Program Studi ARSITEKTUR	TUGAS AKHIR	-	xmpL2Yk

Klik *Create new submission* untuk membuat kelas baru

Kode kelas untuk masuk login upload

5. SELESAI